

# Cooker hood CPD

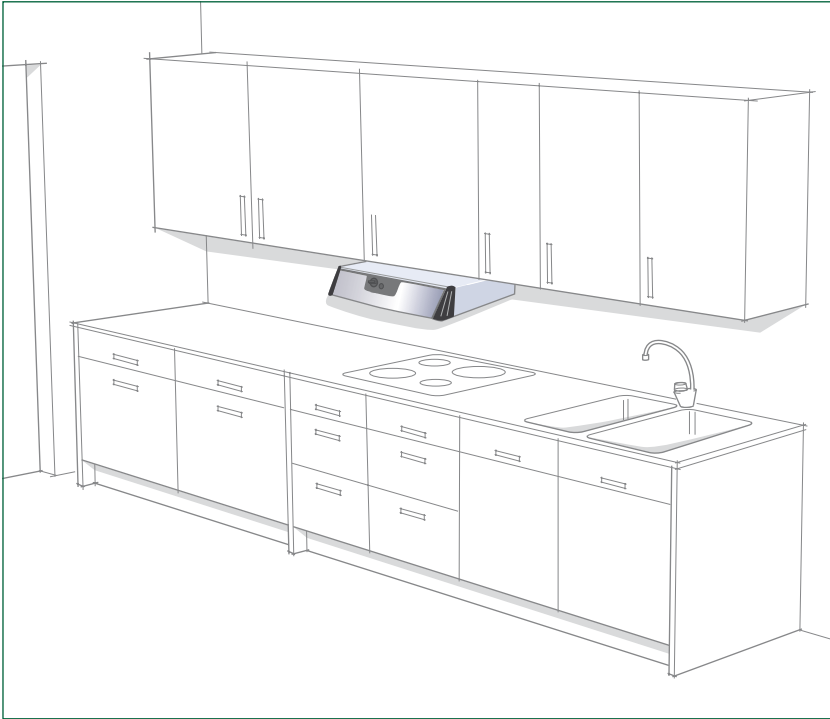

The cooker hood CPD is a newly developed cooker hood with a modern design. The hood is available in white enamelled and stainless steel versions. The cooker hood has easily accessible controls in the middle of the front. The hood is available in a number of variants, for example for multiple-unit dwellings with central extraction, for our heat recovery units and exhaust air fans or for replacing older cooker hoods.

CPD can be used with the following units/exhaust air fans

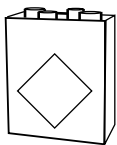

RDKG

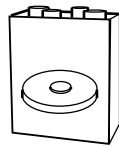

RDKR

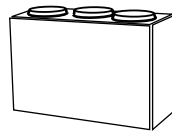

JBDD

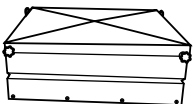

JBFG

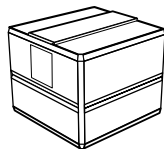

STEF and other central exhaust air fans and units

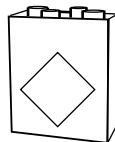

Older units and exhaust air fans

## Product data

- High odour extraction capacity
- Controls easily accessible on the cooker hood front panel
- Cooker lighting with low-energy bulb
- Effective grease filter
- Available in several widths as standard
- Low height which provides plenty of work space under the hood

## Product code example

CPDA-2-03-6-3-1

# Description, materials, control

## Description

The cooker hood has a modern design with controls located in the middle of the front.

The lighting comprises an E14 bulb holder for 11 W low energy bulb which can be replaced without tools.

The low overall height of the cooker hood makes it suitable for installation either under or between high level top cabinets. There are pre-drilled holes for mounting the unit under the cabinets and brackets are supplied for mounting it between the cabinets.

When the hood is used in the Minimaster System together with a heat recovery unit it is installed directly on the unit.

## Materials and coatings

The hood is available in white enamelled or stainless steel versions. The front panel is made of polycarbonate. The knobs and corners are made of black ABS plastic and the lamp glass of polycarbonate. The filter is manufactured in woven aluminium surrounded by rib mesh and an aluminium frame.

## Control

The hood is equipped with a damper for forced air flow. The damper is opened through a knob on the front and has a manually or timer-controlled return (60min).

Some hoods also have a basic air flow and both basic and forced air flow are adjustable. When cleaning the kitchen flue the throttling device can be removed without tools.

Cooker hoods controlling a heat recovery unit or a exhaust air fan also have a knob for fan speed.

The cooker hood CPDJ controlling RDKR has a automatic function that control the fan speed when the throttling device is opened.

The lighting on the cooker hood is lit through a separate switch, see illustrations below.

### CPDA, CPDJ

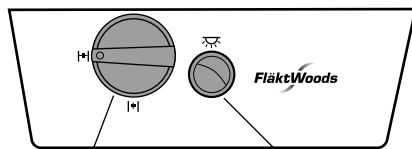

Knob for forcing throttling device      Lighting

### Other CPD cooker hoods

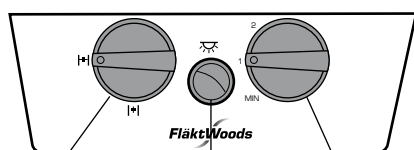

Knob for forcing throttling device      Lighting      Knob for fan speed

## Packaging

The fan is supplied in a cardboard box with all instructional documentation enclosed.

## Models

### CPDA

Intended for multiple-unit dwellings with central extraction or heat recovery unit. Suitable for both new production and replacement of older cooker hoods.

### CPDB

Replacement hood for older exhaust air fan JBDD-aa with condensing apparatus, manufactured before 2007.

### CPDC

Replacement hood for older heat recovery unit RDKG without bypass (fits RDKG-a-1-c-d-1).

### CPDD

Replacement hood for older heat recovery unit ACF and older exhaust air fan BAF.

### CPDG

With transformer, fits for example the new JBDD and JBFG. (Fits JBDD-aa-1-2 but also as replacement hood for controlling older exhaust air fans and units, for example JBDB, JBDC and RDAA.

### CPDH

Replacement hood for older heat recovery units RDKG with bypass. Fits RDKG-a-2-c-d-1.

### CPDJ

For heat recovery unit RDKR.

### CPDK

For heat recovery unit RDKG. Fits RDKG-a-b-c-d-2.

### CPDL

Replacement hood for older heat recovery unit RDKB and RDKE.

# Technical data, dimensions

## Technical data

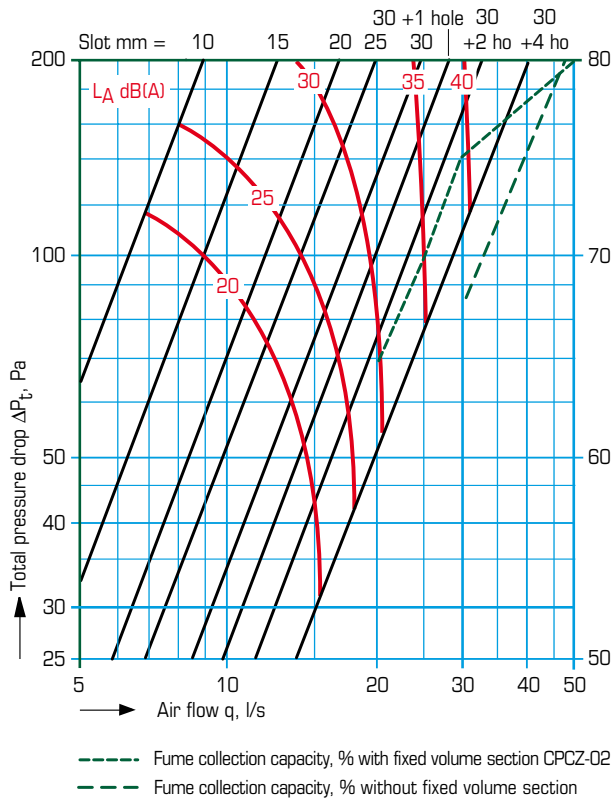

Basic ventilation and fume collection. The throttling device is set to sprint mode 7 and 15 mm slot at delivery.

### In the diagram the following applies:

Pressure drop: Applies to air with a density of 1.2 kg/m<sup>3</sup>.  
 Self generated noise for hoods with throttling devices when installed according to the figure below.

The indicated sound level  $L_A$  applies at a room damping of 4 dB, which corresponds to a damping of the reverberant field in a room with a sound absorption area equivalent to 10 m<sup>2</sup>. Sound value tolerance  $\pm 2$  dB(A).

The cooker hood has been tested concerning fume collection by SP Technical Research Institute of Sweden according to the testing standard SS-EN 61:591.

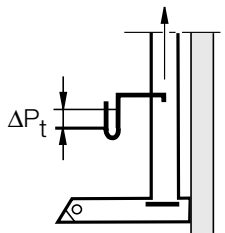

## Dimensions and weight

Dimensions in mm

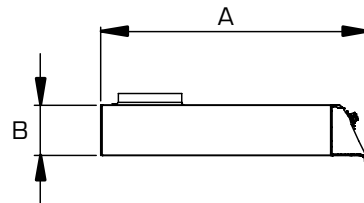
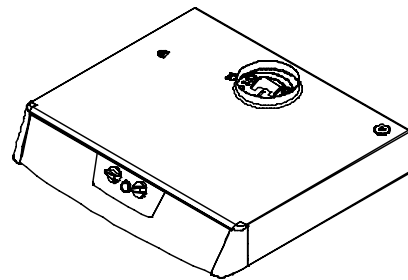
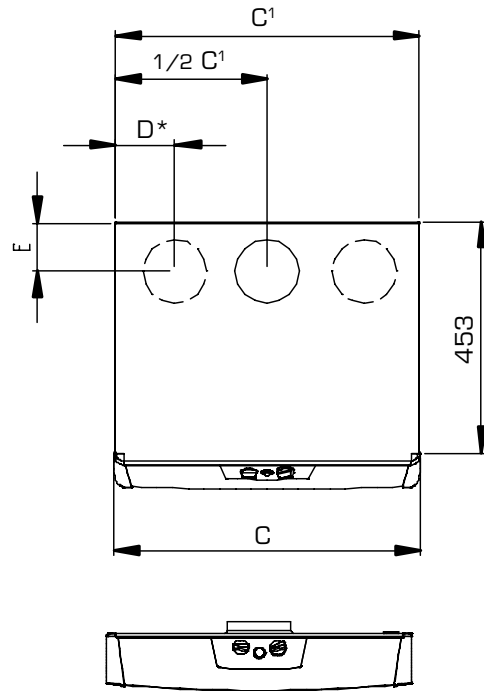

Width	A	B	C	C1	D <sup>1)</sup>	E <sup>1)</sup>	F	W, kg
500	524	100	502	498	114	96	453	4,4
600	524	100	602	598	114	96	453	5,0
700	524	100	702	698	214	96	453	5,9

<sup>1)</sup> The D-measurement is from the right of the hood at right hand side connection. These dimensions are adjusted to the unit for models (CPD) C, D, H, J, K and L.

# Accessories, product code

## Accessories

### Connection kit CPAZ-25

For flexible connection between cooker hood and kitchen flue. The tube is standard-compliant. Two hose clamps are included.

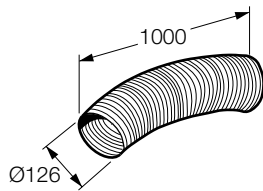

### Bracket set CPAZ-27

For mounting of cooker hood CPDA and CPDG in side cabinet.

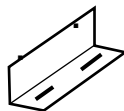

### Fixed volume section, white CPDZ-02, stainless steel CPDZ-06

The accessory consists of two gables to mount on the hood to increase its volume.

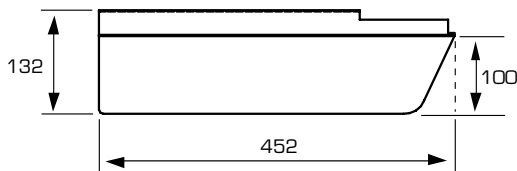

## Product code

### Cooker hood

CPDa-b-cc-d-e-f

Model (a) \_\_\_\_\_

- A
- B
- C
- D
- G
- H
- J
- K
- L

(See page 54 for information about the different models)

Lighting (b) \_\_\_\_\_

2 = Low-energy bulb 11W

Throttling device (cc) \_\_\_\_\_

02 = Manual forcing (only models D and L)  
 03 = Forcing with timer return (not models D and L)

Width (d) \_\_\_\_\_

5 = 500mm (only models A, B and G)  
 6 = 600mm  
 7 = 700mm (not model L)

Connection (e) \_\_\_\_\_

1 = Left-hand side  
 2 = Right-hand side (not models D and L)  
 3 = Middle (only models A and G)

Material (f) \_\_\_\_\_

1 = White  
 2 = Stainless steel

## Accessories

Connection kit	CPAZ-25-000
Bracket set	CPAZ-27-000
Fixed volume section, white	CPDZ-02-000
Fixed volume section, stainless steel	CPDZ-06